

SEE SHEET 2

All house connections are 110 unless otherwise noted.

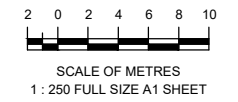

A1

| REV NO | DATE       | REVISION PURPOSE / DESCRIPTION | DRAWN | RPEQ | RPEQ No | INITIALS | DATE |
|--------|------------|--------------------------------|-------|------|---------|----------|------|
| A      | 24.04.2024 | Builders Issue                 |       |      |         |          |      |

|          |    |            |
|----------|----|------------|
| DRAWN    | CM | 22.04.2024 |
| CHECKED  | CU | 26.04.2024 |
| APPROVED |    |            |

**SH saunders havill group**  
 Saunders Havill Group Pty Ltd ABN 54 144 592 540  
 head office 9 Thompson St Bowen Hills Q 4006  
 phone 090 833 5142 www.saundershavill.com  
 ■ surveying ■ town planning ■ urban design ■ environmental management ■ landscape architecture  
 Drawing No: 9780 S 59 AC A



BELLEVUE ESTATE - STAGE 10  
 SUNNY CRESCENT, RIPLEY  
 PLAN OF ADAC SURVEY DATA  
 SEWERAGE RETICULATION 22-PNT-60785

| DRAWING STATUS        |      |
|-----------------------|------|
| <b>AS CONSTRUCTED</b> |      |
| SHEET 1 OF 3 SHEETS   |      |
| DRAWING NO.           | REV. |
|                       | A    |

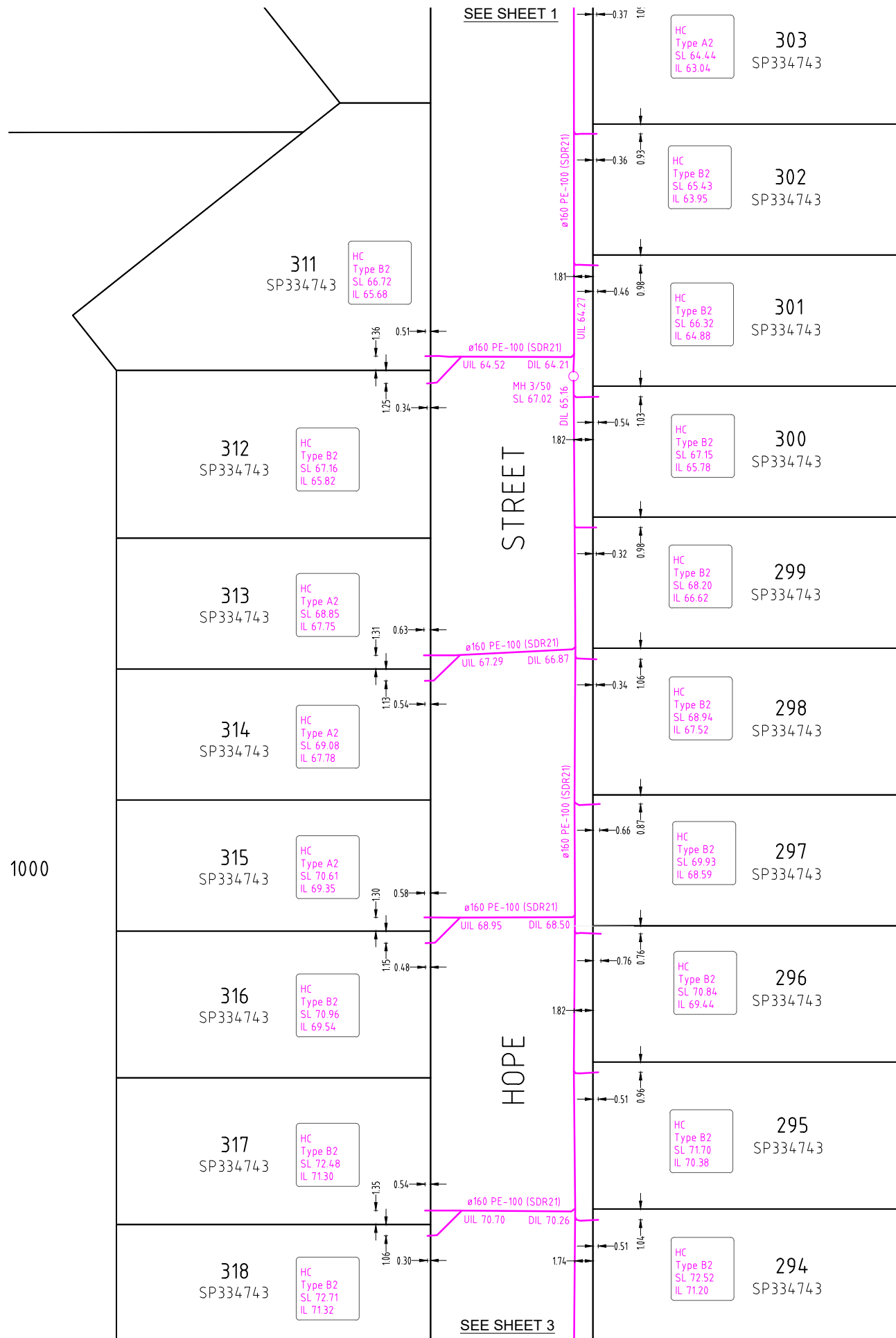

All house connections are  $\phi 110$  unless otherwise noted.

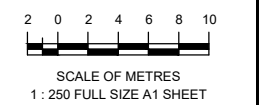

A1

| REV NO | DATE       | REVISION PURPOSE / DESCRIPTION | DRAWN | RPEQ | RPEQ No | INITIALS | DATE |
|--------|------------|--------------------------------|-------|------|---------|----------|------|
| A      | 24.04.2024 | Builders Issue                 |       |      |         |          |      |

|          |    |            |
|----------|----|------------|
| DRAWN    | CM | 22.04.2024 |
| CHECKED  | CU | 26.04.2024 |
| APPROVED |    |            |

**saunders havill group**  
 Saunders Havill Group Pty Ltd ABN 54 144 592 549  
 head office 5 Thompson St Bowen Hills Q 4006  
 phone 090 633 5142 web www.saundershavill.com  
 ■ surveying ■ town planning ■ urban design ■ environmental management ■ landscape architecture  
 Drawing No: 9780 S 59 AC A



BELLEVUE ESTATE - STAGE 10  
 SUNNY CRESCENT, RIPLEY  
 PLAN OF ADAC SURVEY DATA  
 SEWERAGE RETICULATION 22-PNT-60785

| DRAWING STATUS        |      |
|-----------------------|------|
| <b>AS CONSTRUCTED</b> |      |
| SHEET 2 OF 3 SHEETS   |      |
| DRAWING NO.           | REV. |
|                       | A    |



SEE SHEET 2

1000

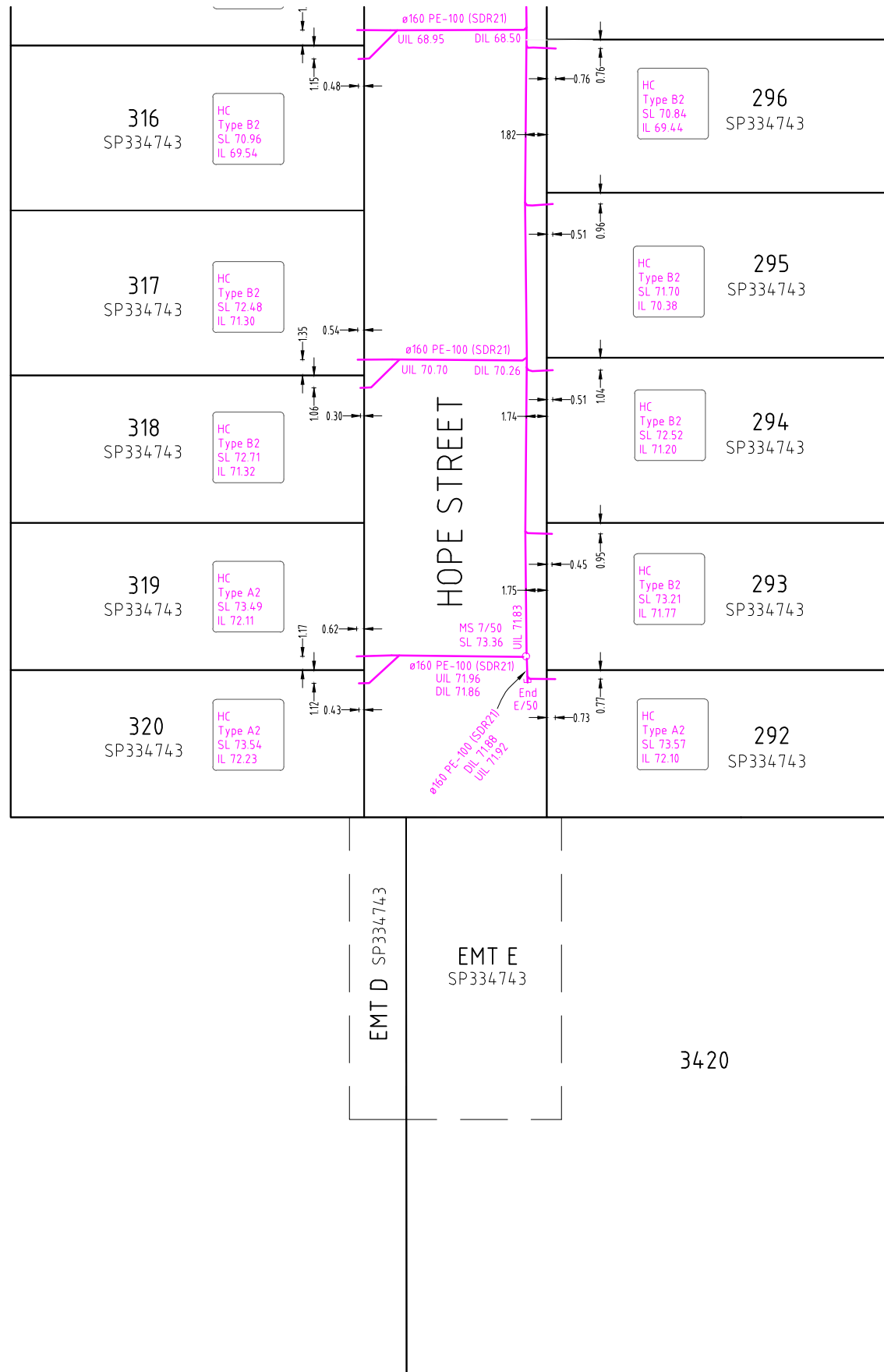

All house connections are ø110 unless otherwise noted.



SCALE OF METRES  
1 : 250 FULL SIZE A1 SHEET

A1

| REV NO | DATE       | REVISION PURPOSE / DESCRIPTION | DRAWN | RPEQ | RPEQ No | INITIALS | DATE |
|--------|------------|--------------------------------|-------|------|---------|----------|------|
| A      | 24.04.2024 | Builders Issue                 |       |      |         |          |      |

|          |    |            |
|----------|----|------------|
| DRAWN    | CM | 22.04.2024 |
| CHECKED  | CU | 26.04.2024 |
| APPROVED |    |            |

**SH saunders havill group**  
 Saunders Havill Group Pty Ltd ABN 54 144 592 540  
 head office 9 Thompson St Bowen Hills Q 4006  
 phone: 090 493 5142 web: www.saundershavill.com  
 ■ surveying ■ town planning ■ urban design ■ environmental management ■ landscape architecture

Drawing No: 9780 S 59 AC A



BELLEVUE ESTATE - STAGE 10  
 SUNNY CRESCENT, RIPLEY  
 PLAN OF ADAC SURVEY DATA  
 SEWERAGE RETICULATION 22-PNT-60785

| DRAWING STATUS        |      |
|-----------------------|------|
| <b>AS CONSTRUCTED</b> |      |
| SHEET 3 OF 3 SHEETS   |      |
| DRAWING NO.           | REV. |
|                       | A    |

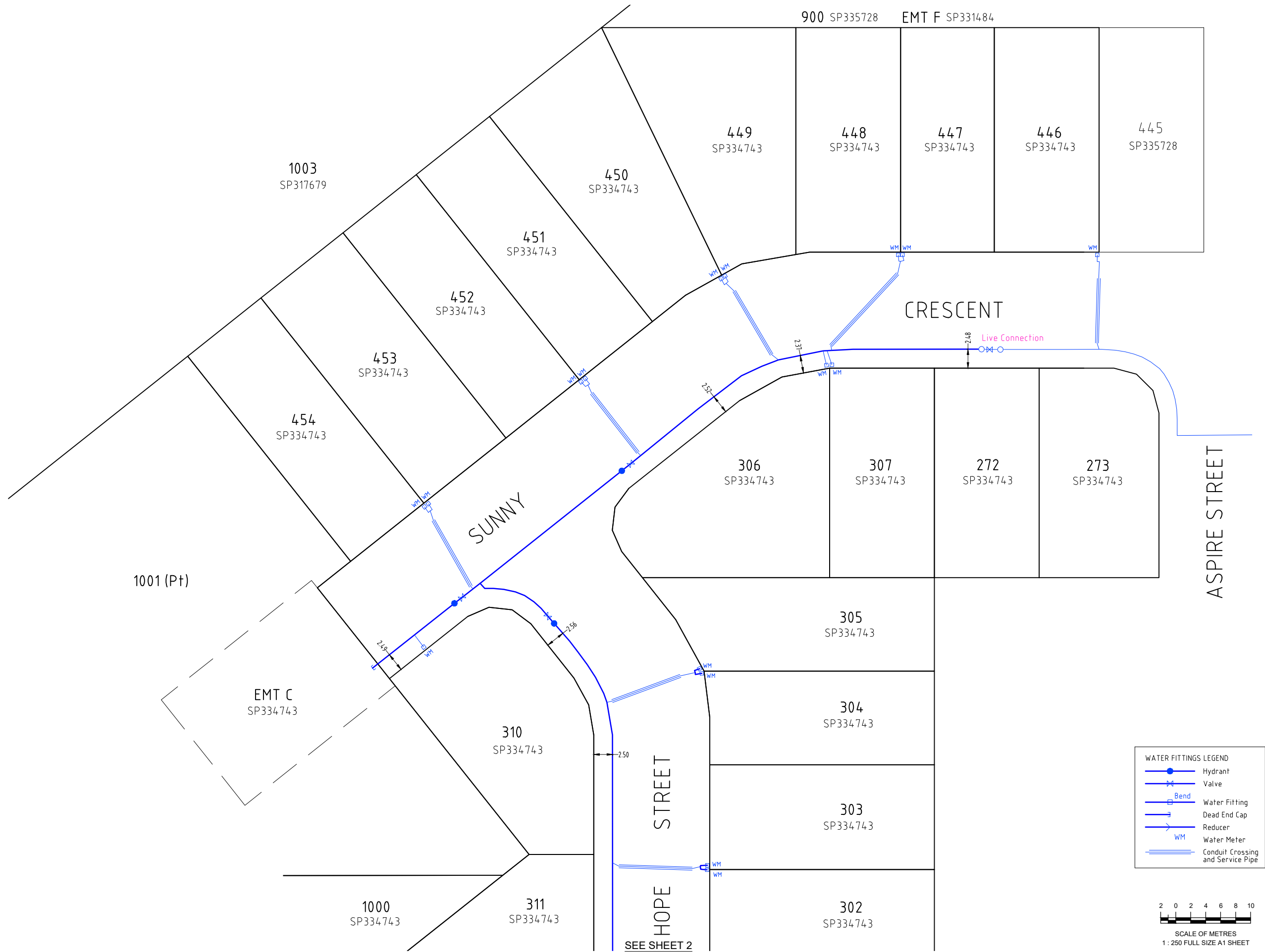

| WATER FITTINGS LEGEND |                                   |
|-----------------------|-----------------------------------|
|                       | Hydrant                           |
|                       | Valve                             |
|                       | Bend                              |
|                       | Water Fitting                     |
|                       | Dead End Cap                      |
|                       | Reducer                           |
|                       | Water Meter                       |
|                       | Conduit Crossing and Service Pipe |

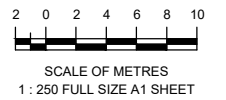

A1

| REV NO | DATE       | REVISION PURPOSE / DESCRIPTION | DRAWN | RPEQ | RPEQ No |
|--------|------------|--------------------------------|-------|------|---------|
| A      | 24.04.2024 | Builders Issue                 |       |      |         |

| DRAWN    | CM | 24.04.2024 |
|----------|----|------------|
| CHECKED  | CU | 26.04.2024 |
| APPROVED |    |            |

**SH saunders havill group**  
 Saunders Havill Group Pty Ltd ABN 24 144 572 540  
 head office 9 Thompson St Bowen Hills Q 4006  
 phone: 090 433 5142 web: www.saundershavill.com  
 ■ surveying ■ town planning ■ urban design ■ environmental management ■ landscape architecture  
 Drawing No: 9780 S 59 AC A



BELLEVUE ESTATE - STAGE 10  
 SUNNY CRESCENT, RIPLEY  
 PLAN OF ADAC SURVEY DATA  
 WATER RETICULATION 22-PNT-60785

| DRAWING STATUS        |      |
|-----------------------|------|
| <b>AS CONSTRUCTED</b> |      |
| SHEET 1 OF 3 SHEETS   |      |
| DRAWING NO.           | REV. |
|                       | A    |

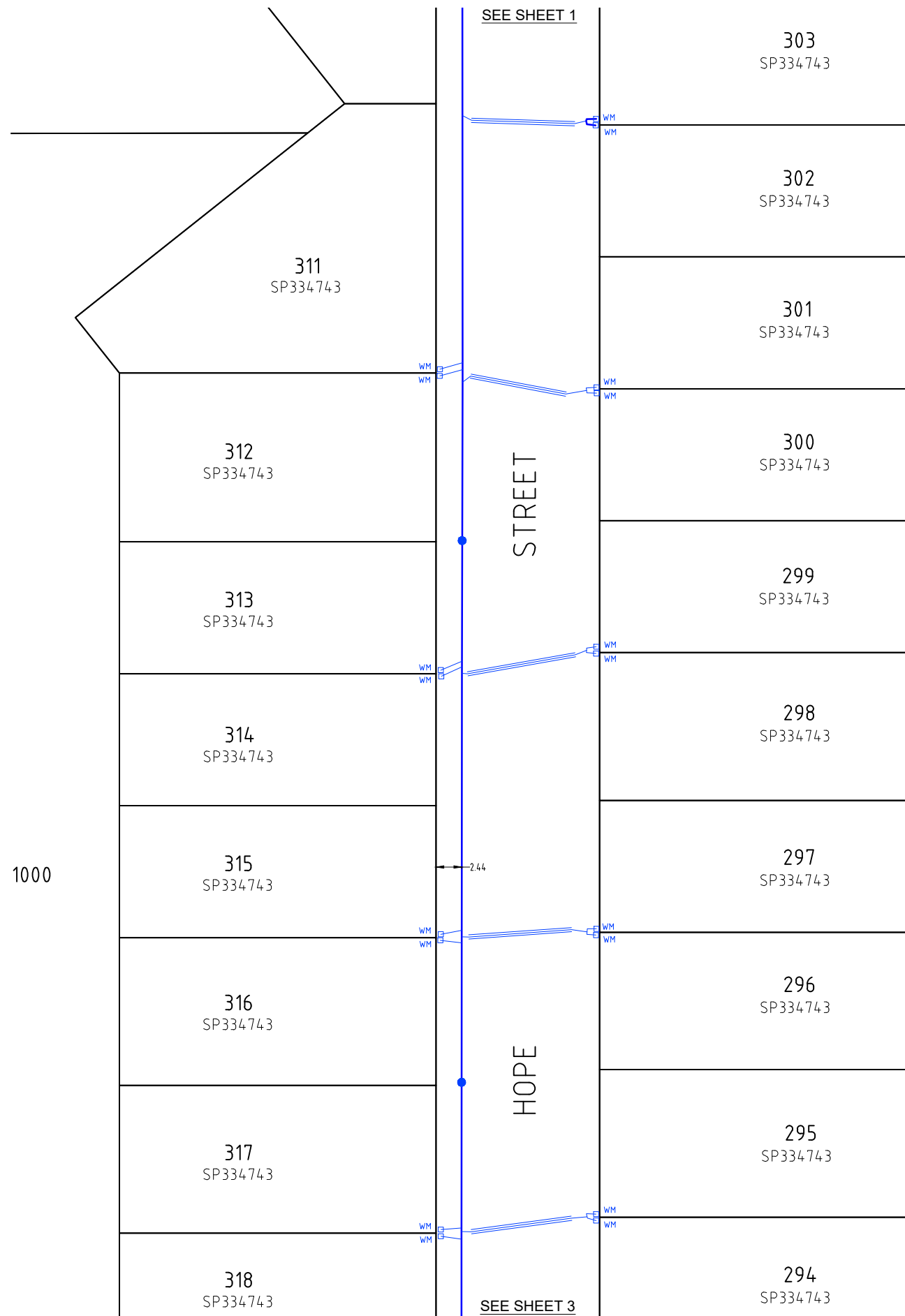

**WATER FITTINGS LEGEND**

|  |                                   |
|--|-----------------------------------|
|  | Hydrant                           |
|  | Valve                             |
|  | Bend                              |
|  | Water Fitting                     |
|  | Dead End Cap                      |
|  | Reducer                           |
|  | Water Meter                       |
|  | Conduit Crossing and Service Pipe |

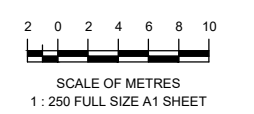

A1

| REV NO | DATE       | REVISION PURPOSE / DESCRIPTION | DRAWN | RPEQ | RPEQ No | APPROVED | INITIALS | DATE |
|--------|------------|--------------------------------|-------|------|---------|----------|----------|------|
| A      | 24.04.2024 | Builders Issue                 |       |      |         |          |          |      |

|          |    |            |
|----------|----|------------|
| DRAWN    | CM | 24.04.2024 |
| CHECKED  | CU | 26.04.2024 |
| APPROVED |    |            |

**SH saunders havill group**  
 Saunders Havill Group Pty Ltd ABN 24 144 572 540  
 head office 9 Thompson St Bowen Hills Q 4006  
 phone: 090 433 5142 web: www.saundershavill.com  
 ■ surveying ■ town planning ■ urban design ■ environmental management ■ landscape architecture

Drawing No: 9780 S 59 AC A



BELLEVUE ESTATE - STAGE 10  
 SUNNY CRESCENT, RIPLEY  
 PLAN OF ADAC SURVEY DATA  
 WATER RETICULATION 22-PNT-60785

|   |           |
|---|-----------|
| DRAWING STATUS<br><b>AS CONSTRUCTED</b> |           |
| SHEET 2 OF 3 SHEETS                     |           |
| DRAWING NO.                             | REV.<br>A |

SEE SHEET 2



1000

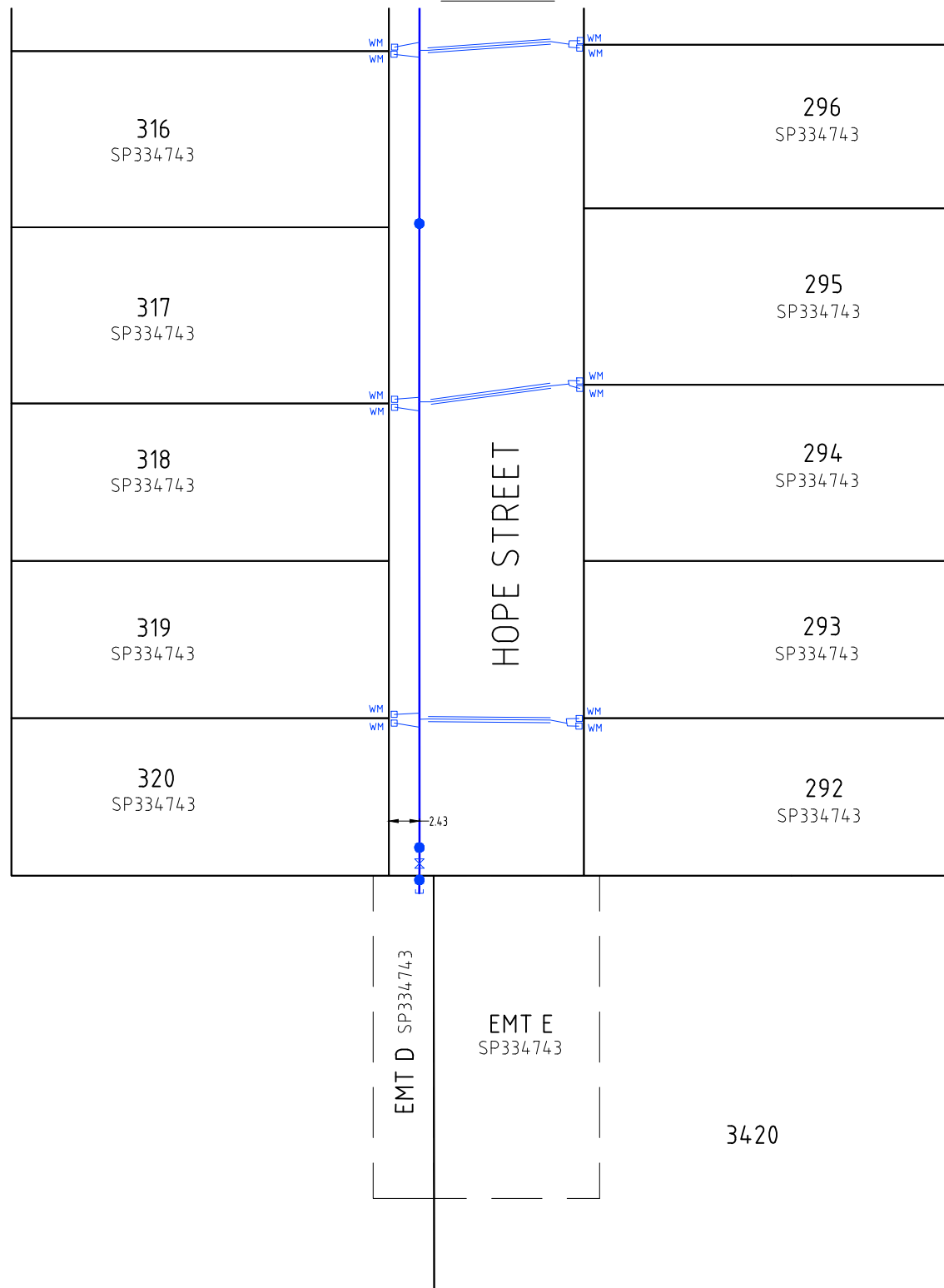

| WATER FITTINGS LEGEND |                                   |
|-----------------------|-----------------------------------|
|                       | Hydrant                           |
|                       | Valve                             |
|                       | Water Fitting                     |
|                       | Dead End Cap                      |
|                       | Reducer                           |
|                       | Water Meter                       |
|                       | Conduit Crossing and Service Pipe |

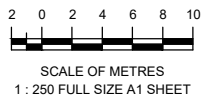

A1

| REV NO | DATE       | REVISION PURPOSE / DESCRIPTION | DRAWN | RPEQ | RPEQ No |
|--------|------------|--------------------------------|-------|------|---------|
| A      | 24.04.2024 | Builders Issue                 |       |      |         |

|          |    |            |
|----------|----|------------|
| DRAWN    | CM | 24.04.2024 |
| CHECKED  | CU | 26.04.2024 |
| APPROVED |    |            |



BELLEVUE ESTATE - STAGE 10  
SUNNY CRESCENT, RIPLEY  
PLAN OF ADAC SURVEY DATA  
WATER RETICULATION 22-PNT-60785

| DRAWING STATUS        |      |
|-----------------------|------|
| <b>AS CONSTRUCTED</b> |      |
| SHEET 3 OF 3 SHEETS   |      |
| DRAWING NO.           | REV. |
|                       | A    |

Drawing No: 9780 S 59 AC A